



**HERBERT KREITEL**  
**Feinmechanische Werkstätten**  
 Vermessungs-, Navigations-  
 und Kontrollinstrumente  
 Inh. Norbert Kreitel  
 Taunusstrasse 30  
 53119 Bonn  
 Germany  
 Tel. +49 (0) 2 28 65 47 60  
 Fax +49 (0) 2 28 69 74 93  
 www.kreitel-vermessungsgeraete.de  
 info@kreitel-vermessungsgeraete.de

Laser class 2 in acc. with IEC 60825-1

www.disto.com



SAP. No. 792 313

## Insert batteries

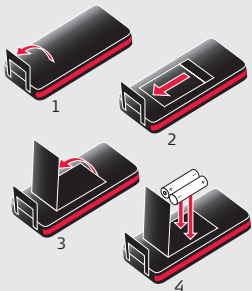

## Operation



## Endpiece

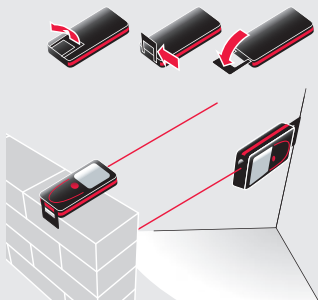

## Overview

- 1 Status Bar/Level
- 2 Reference
- 3 Active Function
- 4 Main Line (Result)
- 5 Selection keys linked to the symbol above
- 6 ON/DIST
- 7 Pointfinder (viewscreen)
- 8 Function Screen
- 9 Navigation
- 10 Clear/Off
- 11 Add/Subtract

## Unlock keypad

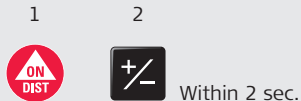

## Quick Start

### Leica DISTO™ D510



- when it has to be right

**Leica**  
 Geosystems

## (Navigate) Functions

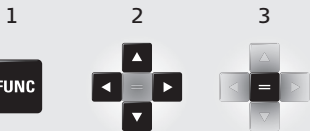

## Reference/Tripod



## More Results

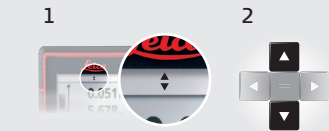

## Pointfinder

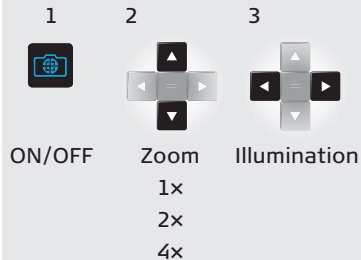

## ? Helpfunctions

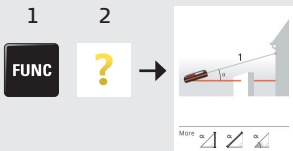

## Settings

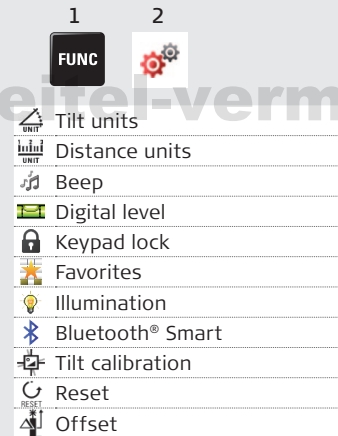

## Memory



## Personalized Favorites

